

DESCRIPTION

T90RB

Pressure ports



DIMENSIONS

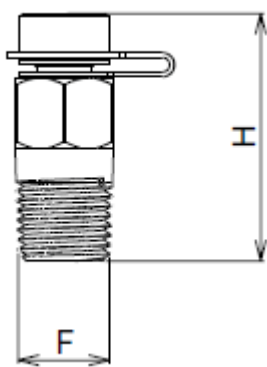

F	1/4"
H	36
Weight (g)	30

All threads are conform to ISO7/1 standards

MATERIALS

Body Brass CW614N (DIN 50930 part.6) CuZn39Pb3

VARIANTS

T90BLU Blue Type only

RECOMMENDED WORKING TEMPERATURE/ PRESSURE LIMIT
 25 bar - 120°C - non shock