



DESCRIPTION

G51

F x F Heavy duty full-flow ball valve.
Yellow steel lever.

Conform to **EN 331** standard.

DIMENSIONS

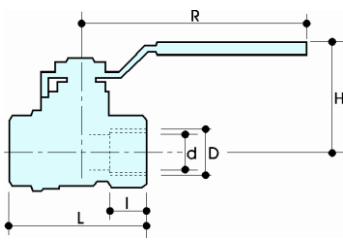

| D | 1/4" | 3/8" | 1/2" | 3/4" | 1" | 1 1/4" | 1 1/2" | 2" | 2 1/2" | 3" | 4" |
|------------|------|------|------|------|------|--------|--------|------|--------|------|-------|
| d | 10 | 10 | 15 | 20 | 25 | 32 | 40 | 50 | 63 | 76 | 100 |
| H | 36 | 36 | 39 | 49 | 61 | 66 | 82 | 89 | 120 | 135 | 150 |
| I | 11.5 | 12 | 17 | 18 | 21.5 | 23.5 | 23.5 | 28 | 32 | 34.5 | 42 |
| L | 46 | 47 | 62 | 69 | 84 | 96 | 106 | 127 | 154 | 180 | 220 |
| R | 75 | 75 | 75 | 95 | 120 | 120 | 150 | 150 | 200 | 200 | 250 |
| Ch | 17 | 21 | 26 | 32 | 40 | 49 | 56 | 69 | 84 | 98 | 128 |
| Acc. Type | 1 | 1 | 1 | 2 | 3 | 3 | 4 | 4 | 5 | 5 | 6 |
| PN | 8 | 8 | 8 | 8 | 8 | 8 | 8 | 8 | 5 | 5 | 5 |
| Weight (g) | 145 | 145 | 230 | 370 | 660 | 1000 | 1380 | 2220 | 3860 | 5940 | 11300 |

Dimension in mm

All threads are conform to ISO 7 or ISO 228 standards

MATERIALS

| | |
|----------------|---|
| Body | Brass CW617N (DIN 50930 part.6) CuZn40Pb2 |
| Ball | Brass CW617N (DIN 50930 part.6) CuZn40Pb2 Chrome plated |
| Stem | Brass CW614N (DIN 50930 part.6) CuZn39Pb3 |
| Gland | Brass CW614N (DIN 50930 part.6) CuZn39Pb3 |
| Seat | 2 x PTFE |
| O-rings | 2 x NBR PTFE packing |
| Lever | Galvanised steel PVC grip with "Pad Printing" |

CONNECTION VARIANTS

| | |
|-------|---------------------------|
| G51 | F X F, Yellow steel lever |
| G51/1 | F X M, Yellow steel lever |
| G51/2 | M X M, Yellow steel lever |

HANDLE VARIANTS

| | |
|-----|-------------------------|
| G50 | Yellow aluminum lever |
| G51 | Yellow steel lever |
| G52 | Yellow butterfly handle |
| G56 | Yellow cap |

PRESSURE DROP DIAGRAM

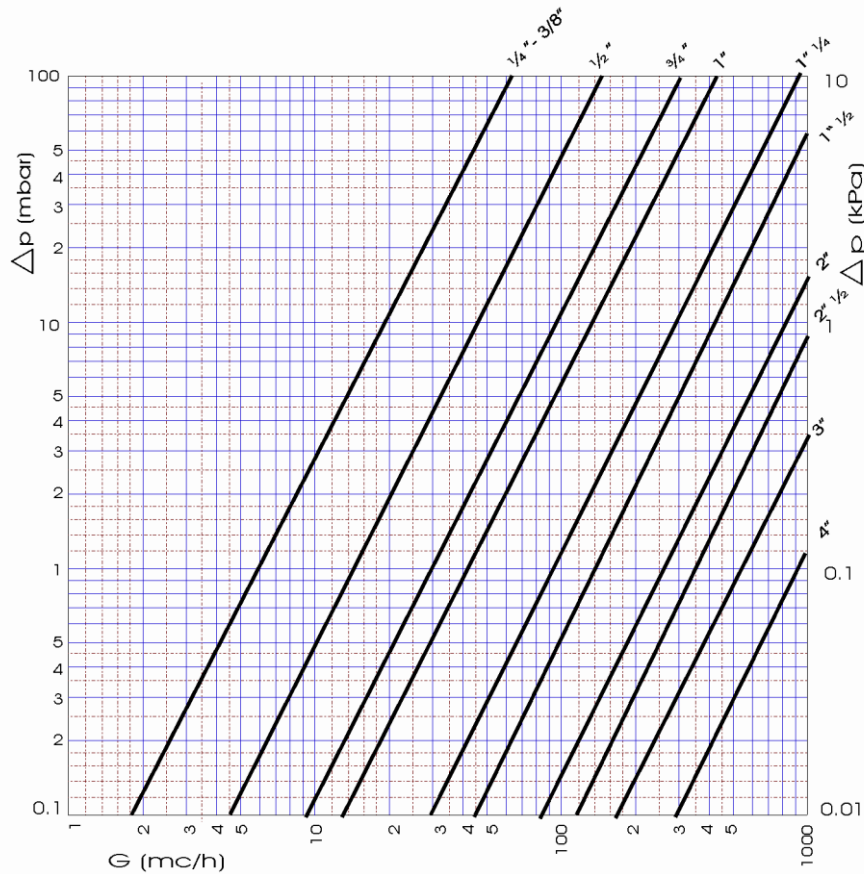

RECOMMENDED WORKING TEMPERATURE/ PRESSURE LIMIT

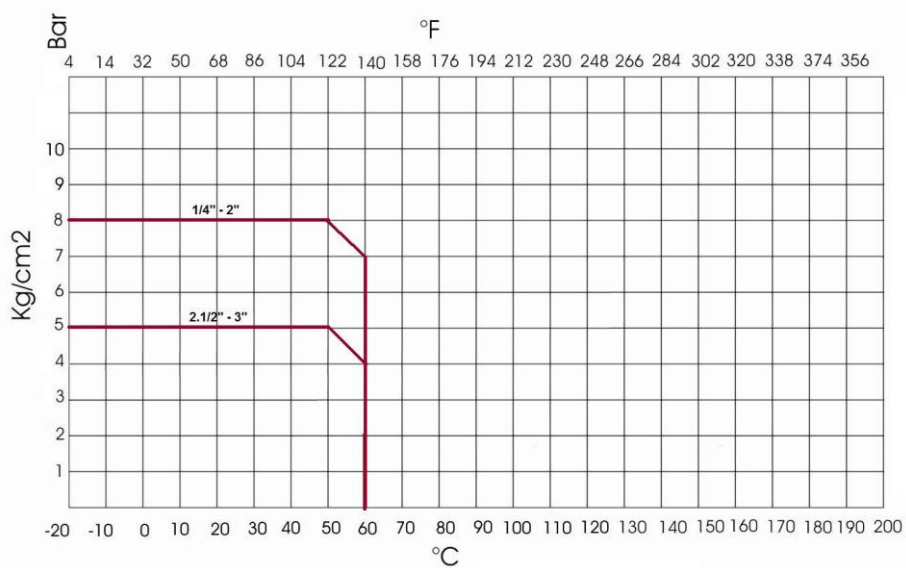

Working temperature range : -20 + 60°C