



DESCRIPTION

# 701CG

Water meter bracket with adjustable non-return valve.

Lead content CW724R <0,1%. Male x swivel. With hole for sealing.

1 piece. with adjustable non-return valve and 1 pc. without non-return valve.

Backflow category 2 protection according to EN1717.

DIMENSIONS

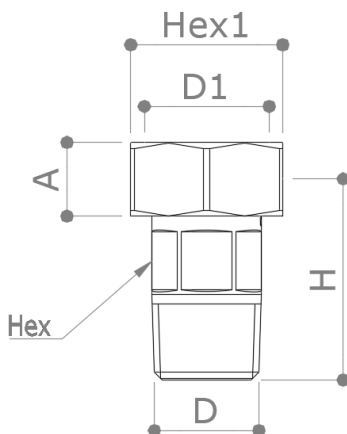

<b>D</b>	<b>1/2"</b>	<b>3/4"</b>
<b>D1</b>	<b>3/4"</b>	<b>1"</b>
<b>A</b>	13	16
<b>H</b>	40,5	50,5
<b>Hex</b>	16	22
<b>Hex1</b>	30	38
<b>Weight [g]</b>	167	294

Dimensions in mm

All threads according to EN 10226-1 standards.

MATERIALS

**Male** CW724R 0,1%

**Swivel** CW617N-DW

**Seal** EPDM

RECOMMENDED WORKING TEMPERATUR/PRESSURE LIMITS

10 bar – 70°C – non shock

1°C: Minimum temperatur. No frost.

CW724R (Eco brass®) is a lead free brass with lead content less than 0,1% and therefore ...

... is suitable for use in installations with potable water;

... is approved according to EU Directive DWD 98/83/EG as well as 4MS, UBA list;

... meets the RoHS and ELV requirements;

CW724R (Eco brass®) do not contain any toxic substance.

CW724R (Eco brass®) has mechanical characteristics that are exceptionally high for a brass material. Depending on dimensions the tensile strength value can reach 1000Mpa that fully match some steel grade.

CW724R (Eco brass®) has a corrosion resistance (DZR) significantly superior to the conventional brass. The addition of silicon raises tarnish-resistance and reduces susceptibility to dezincification and stress corrosion cracking. The dezincification resistance, tested according to ISO6509, is comparable with dezincification-resistance brasses as CW602N.

CW724R (Eco brass®) components under the stress corrosion cracking test according to DIN 50916 Part 1, even without any additional heat treatment, show no defects.